

LICENSING ACT 2003 SUB-COMMITTEE

THURSDAY 26 JUNE 2014

1.30 PM

Bourges/Viersen Rooms - Town Hall

AGENDA

Page No

1. Apologies for Absence

2. Declarations of Interest

At this point Members must declare whether they have a disclosable pecuniary interest, or other interest, in any of the items on the agenda, unless it is already entered in the register of members' interests or is a "pending notification" that has been disclosed to the Solicitor to the Council.

Members must also declare if they are subject to their party group whip in relation to any items under consideration.

3. Application for a New Premises Licence - General Store, 48 Oundle Road, Peterborough

3 - 72



There is an induction hearing loop system available in all meeting rooms. Some of the systems are infra-red operated, if you wish to use this system then please contact Philippa Turvey on 01733 452460 as soon as possible.

Committee Members:

Councillors: P Thacker (Chairman), N Khan and B Saltmarsh

Further information about this meeting can be obtained from Philippa Turvey on telephone 01733 452460 or by email – philippa.turvey@peterborough.gov.uk

LICENSING ACT 2003 SUB COMMITTEE		AGENDA ITEM No. 3
26 JUNE 2014		PUBLIC REPORT
Contact Officers:	Adrian Day, Licensing Manager Darren Dolby, Licensing Regulatory Officer	Tel: 454437 Tel. 453561

APPLICATION: NEW PREMISES LICENCE

APPLICANT: Mr Adem Xhemajli

REFERENCE NO: 069399

PREMISES: General Store, 48 Oundle Road, Peterborough, PE2 9PA

GLOSSARY OF TERMS: Attached at **Appendix 1**

1. PURPOSE OF REPORT

1.1 To consider and determine this application for a new premises licence for General Store, 48 Oundle Road, Peterborough, taking into account the representations received from 256 persons and one local Councillor who are all, under the Licensing Act 2003, defined as 'other persons'.

2. BACKGROUND INFORMATION

- 2.1 There has been no previous premises licence issued to this premises.
- 2.2 The premises is currently trading as a self-contained shop supplying East European food.

3. AUTHORISATIONS AND TIMES APPLIED FOR

- **Sale of alcohol for consumption off the premises**

Sunday to Wednesday 09.00 to 21.00
Thursday to Saturday 09.00 to 23.00

- **Hours premises are open to the public**

Monday to Sunday 09.00 to 21.00
Thursday to Saturday 09.00 to 23.00

4. APPLICATION

4.1 Please refer to the application attached at **Appendix B**.

- 4.2 Representations have been received from one local Councillor (**Appendix C**) and 256 'other persons'. These are attached at **Appendix D**.
- 4.4 Part P of the application sets out the applicant's proposed conditions under the licensing objectives, these being, 'The Prevention of Public Nuisance', 'Public Safety', 'Prevention of Crime and Disorder' and 'The Protection of Children from Harm'. These are also contained within the body of this report (in section 7) and in accordance with section 10.5 of Guidance have been interpreted into enforceable conditions. Only those appropriate and proportionate for the promotion of the licensing objectives have been included in the Operating Schedule.
- 4.5 No representations have been received from any of the Responsible Authorities i.e. Cambridgeshire Constabulary, Peterborough City Council Trading Standards, Public Health Authority, Cambridgeshire Fire and Rescue Service, Licensing Authority, Peterborough City Council Planning Department, Peterborough City Council Health & Safety Department, Children's Services or Peterborough City Council Environmental Pollution Team.
- 4.6 A 'Notice' was displayed in the newspaper in accordance with Part 4 No. 25 of Statutory Instruments 2005 No. 42 – The licensing Act 2003 (Premises Licences and Club Premises Certificates) Regulations 2005.

5. OTHER PERSONS

5.1 Summary of issues raised

- If granted it would contribute to an increase in street drinking in the area.
- If granted it could lead to a rise in anti social behaviour
- If granted it would lead to an increase in noise and disturbance in the area.
- Already an adequate number of premises selling alcohol in the area.

6. MEDIATION

6.1 No mediation has taken place.

7. APPLICANT'S PROPOSED CONDITIONS UNDER THE LICENSING OBJECTIVES:

7.1 Crime and disorder

- CCTV cameras will be installed in the premises.

7.2 Prevention of Public Nuisance

- No conditions proposed by applicant.

7.3 Protection of children from harm

- Any person selling or supplying alcohol under the authority of a personal licence holder must ask for a photo ID proof where they have reason to suspect the individual may be under 25 years of age

7.4 Public Safety

- All escape routes and exits will be properly maintained.
- Notices detailing the action to be taken in the event of fire or other emergencies, including how the fire brigade should be summoned, shall be prominently displayed and protected from damage and deterioration
- An adequate and appropriate supply of first aid equipment and materials shall be available on the premises.

- A notice will be placed at the premises exit requesting customers purchasing alcohol to dispose of their cans or bottles responsibly.

8. POLICY & GUIDANCE IMPLICATIONS

8.1 The following sections/paragraphs are applicable to this application:

8.2 Council's Statement of Licensing Policy

- Objectives, Section 4 on Page 5 and 6
- Fundamental Principles, Section 6 on Page 6
- Cumulative Effect, Section 11 on Page 8 to 10
- Children and Licensed Premises, Section 13 on Page 10 and 11
- Licence Conditions, Section 14 page 11 and 12
- Delegation / Decision Making / Administration, Section 17 on Page 13 and 14

8.3 Guidance Issued under Section 182 of the Licensing Act 2003 June 2013

- The Licensing Objectives – Section 2 pages 11 to 16
- Applications for Premises Licences – Section 8 pages 42 to 48
- Determining applications – Section 9 pages 58 to 64
- Conditions Attached to Premises Licences – Section 10 page 65 to 74

9. LICENSING OFFICER'S COMMENT (FOR INFORMATION)

9.1 Regulation 19(a) requires authorities to disregard any information given by a party or person that is "not relevant" to the application.

9.2 Members should note that the letters and petition attached are in their entirety and that not all matters raised within the representations are relevant matters for consideration under the Licensing Act 2003. It is up to the Committee to decide upon what 'weight' they attach to these areas. There are a number of petition representations that have been discounted due to not fulfilling the criteria required to be valid. These are indicated with an asterisk in the appendix.

10. LEGAL OFFICER'S COMMENTS

10.1 The Licensing Authority (hereafter referred to as "the Council) is charged with implementing the provisions of the Licensing Act 2003. This is an application for a new licence made under Section 17 of the Licensing Act.

10.2 In this case, the application was received at these offices on 1 May 2014.

10.3 The application before this committee will be treated on its own merits, and the Licensing committee will make its decision based upon

- The merits of the application
- The promotion of the four licensing objectives
- The statement of policy of the Licensing Authority
- The Guidance issued by the Secretary of State for Culture, Media and Sport under section 182 of the Licensing Act 2003 – October 2012

10.4 The licensing authority may determine the application, depending upon what is appropriate for the promotion of the licensing objectives, in any of the following ways:

- Decide to grant the licence in the same terms as it was applied for
- Decide to grant the licence, but to modify or add conditions (to promote the licensing objectives)
- Exclude from the scope of the licence a licensable activity

- Decide to refuse to grant the licence

10.5 Conditions are modified if they are altered, omitted or any new condition added (Section 35(4) Licensing Act 2003).

LICENSING ACT 2003 GLOSSARY OF TERMS

Note: In this document, the following definitions are included to provide an explanation of certain terms included in the Act. In some cases they are an abbreviation of what is stated in the Licensing Act 2003 or an interpretation of those terms. For a full definition of the terms used, the reader must refer to the Licensing Act 2003.

‘Child’

- (a) means an individual aged under 16
- (b) a child is unaccompanied if he is not in the company of an individual aged 18 years or over

DCMS: Department for Culture Media and Sport

‘Designated Premises Supervisor’ means the person (who must be a Personal Licence Holder), in the case of premises selling alcohol, who will normally have been given the day to day responsibility for running the premises by the holder of the Premises Licence or will be the Premises Licence holder.

‘Other Persons’:

- persons who live, or are involved in a business, in the relevant licensing Authorities area and who are likely to be affected by the application and are not a Responsible Authority.

‘Late Night Refreshment’ means the supply of hot food or hot drink to members of the public (whether for consumption on or off the premises) between the hours of 11.00 pm and 5.00 am.

‘Licensable Activities’ means: -

- The sale by retail of alcohol
- The supply of alcohol by or on behalf of a club to, or to the order of, a member of the club
- The provision of Regulated Entertainment
- The provision of Late Night Refreshment

‘Licensing Authority’: - is the licensing function of Peterborough City Council

‘Licensed Premises’ includes club premises and events unless the context otherwise requires.

‘Licensing Objectives’

- The prevention of crime and disorder
- Public safety
- The prevention of public nuisance
- The protection of children from harm

‘Operating Schedule’ means a document containing a statement of the following matters (and any others that may be prescribed): -

- The relevant Licensable Activities
- The times at which the Licensable Activities are to take place and any other times when premises are open to the public
- Information regarding the person who will be specified in the Premises Licence as the Premises Supervisor
- Where the Licensable Activities involve the supply of alcohol, whether it is for the supply on and/or off the premises
- The steps being taken to promote the Licensing Objectives

'Rateable Value': as regards a premises, is the value for the time being in force for the premises entered in the local non-domestic rating list for the purposes of Part III of the Local Government Finance Act 1988(b).

'Regulated Entertainment' (Schedule 1 of the Act) means: -

- A performance of a play
- An exhibition of a film
- An indoor sporting event
- A boxing or wrestling entertainment
- A performance of live music
- Any playing of recorded music
- A performance of dance

Or entertainment of a similar description falling within the last three of the categories listed above, where the entertainment takes place in the presence of and for the purposes of entertaining that audience or spectators.

Or the provision of entertainment facilities:

Facilities for enabling persons to take part in entertainment of the following description for the purpose or purposes, which include the purpose of being entertained:

- making music
- dancing
- entertainment of a similar description

'Relevant Licensing Authority': is the Authority in the area the premises are situated.

'Responsible Authority' means any of the following: -

- Cambridgeshire Constabulary (The Chief Officer of Police)
- Cambridgeshire Fire and Rescue (The Fire Authority)
- Health and Safety Team, Peterborough City Council
- Planning authority, Peterborough City Council
- Trading Standards, Peterborough City Council
- Environmental Health – Pollution, Peterborough City Council
- Children's Services – Child Protection & Review Manager
- Primary Care Trust or Local Health Board (Director of Public Health)
- The Relevant Licensing Authority, Peterborough City Council
- Maritime & Coastguard Agency, Walton on Naze. (For vessels carrying more than 12 passengers.)
- Environment Agency, Peterborough (For vessels carrying 12 or less passengers).

'Supply of alcohol':

- the sale by retail of alcohol, or
- the supply of alcohol by or on behalf of a club to, or to the order of, a member of the club.

'Temporary Event Notice' means a Permitted Temporary Activity involving one or more Licensable Activities subject to the following various conditions and limitations: -

- Duration – they are limited to events lasting for up to 168 hours (7 days);
- Scale – they cannot involve the presence of more than 499 people at any one time;
- Use of the same premises – the same premises cannot be used on more than 12 occasions in a calendar year, but are subject to the overall aggregate of 21 days irrespective of the number of occasions on which they have been used; and

- The number of notices given by an individual within a given period of time – a Personal Licence Holder is limited to 50 notices in one year and another person to 5 notices in a similar period.

(In any other circumstances, a full Premises Licence or Club Premises Certificate will be required for the period of the event).

‘the Act’: means the Licensing Act 2003

This page is intentionally left blank

PETERBOROUGH CITY COUNCIL

- 1 MAY 2014

**L2****LICENSING****OPERATIONS**

**Peterborough City Council, Licensing Section, Fourth Floor,
Bayard Place, Broadway, Peterborough, PE1 1HZ**

**Application for a premises licence to be granted under the
Licensing Act 2003**

PLEASE READ THE FOLLOWING INSTRUCTIONS FIRST

Before completing this form please read the guidance notes at the end of the form
If you are completing this form by hand please write legibly in block capitals. In all cases ensure that your answers are inside the boxes and written in black ink. Use additional sheets if necessary.

You may wish to keep a copy of the completed form for your records.

I/We Adem Xhemajli apply for a premises licence under section 17 of the Licensing Act 2003 for the premises described in Part 1 below (the premises) and I/we are making this application to you as the relevant licensing authority in accordance with section 12 of the Licensing Act 2003

Part 1 – Premises details

Postal address of premises or, if none, ordnance survey map reference or description	
48 OUNDLE ROAD	
Post town	PETERBOROUGH
Post Code	PE2 9PA

Telephone number at premises (if any)

01733 739851

Non-domestic rateable value of premises

4000

Part 2 - Applicant details

Please state whether you are applying for a premises licence as
Please tick ✓ yes

- a) an individual or individuals* please complete section (A)
- b) a person other than an individual*

i. as a limited company please complete section (B)

ii. as a partnership please complete section (B)

iii. as an unincorporated association or please complete section (B)

APPENDIX B

- iv. other (for example a statutory corporation) please complete section (B)

- c) a recognised club please complete section (B)
- d) a charity please complete section (B)
- e) the proprietor of an educational establishment please complete section (B)
- f) a health service body please complete section (B)
- g) a person who is registered under Part 2 of the Care Standards Act 2000 (c14) in respect of an independent hospital please complete section (B)

- h) the chief officer of police of a police force in England and Wales please complete section (B)

*If you are applying as a person described in (a) or (b) please confirm:

Please tick yes

I am carrying on or proposing to carry on a business which involves the use of the premises for licensable activities; or

I am making the application pursuant to a
- statutory function or
- a function discharged by virtue of Her Majesty's prerogative

(A) **INDIVIDUAL APPLICANTS** (fill in as applicable)

Mr Mrs Miss Ms Other title
(for example, Rev)

Surname

First names

I am 18 years old or over

Please tick yes

Current postal address if different from premises address

Post Town

Postcode

Daytime contact telephone number

E-mail address (optional)

APPENDIX B

SECOND INDIVIDUAL APPLICANT (if applicable)

Mr Mrs Miss Ms Other title
(for example, Rev)

Surname

First names

I am 18 years old or over

Please tick yes

Current postal address if different from premises address

Post Town

Postcode

Daytime contact telephone number

E-mail address (optional)

(B) OTHER APPLICANTS.

Please provide name and registered address of applicant in full. Where appropriate please give any registered number. In the case of a partnership or other joint venture (other than a body corporate), please give the name and address of each party concerned

Name
Address
Registered number (where applicable)
Description of applicant (for example partnership, company, unincorporated association etc)
Telephone number (if any)
E-mail address (optional)

APPENDIX B

Part 3 Operating Schedule

When do you want the premises licence to start?

Day Month Year

30 04 2014

If you wish the licence to be valid only for a limited period, when do you want it to end?

Day Month Year

If 5,000 or more people are expected to attend the premises at any one time, please state the number expected to attend.

Please give a general description of the premises (please read guidance note1)

SELF CONTAINED SHOP SUPPLYING EASTERN EUROPEAN FOOD CONSISTING OF ONE GROUND FLOOR LEVEL IN CENTRAL PETERBOROUGH

What licensable activities do you intend to carry on from the premises?

(Please see sections 1 and 14 of the Licensing Act 2003 and Schedule 1 and 2 to the Licensing Act 2003)

Please tick ✓ yes

Provision of regulated entertainment

- a) plays (if ticking yes, fill in box A)
b) films (if ticking yes, fill in box B)
c) indoor sporting events (if ticking yes, fill in box C)
d) boxing or wrestling entertainment (if ticking yes, fill in box D)
e) live music (if ticking yes, fill in box E)
f) recorded music (if ticking yes, fill in box F)
g) performances of dance (if ticking yes, fill in box G)
h) anything of a similar description to that falling within (e), (f) or (g) (if ticking yes, fill in box H)

Provision of entertainment facilities for:

- i) making music (if ticking yes, fill in box I)
j) dancing (if ticking yes, fill in box J)
k) entertainment of a similar description to that falling within (i) or (j) (if ticking yes, fill in box K)

Provision of late night refreshment (if ticking yes, fill in box L)

Supply of alcohol (if ticking yes, fill in box M)

APPENDIX B

In all cases complete boxes N, O and P

A

Plays Standard days and timings (please read guidance note 6)			Will the performance of a play take place indoors or outdoors or both – please tick [Y] (please read guidance note 2)	Indoors	
Day	Start	Finish		Outdoors	
Mon			Please give further details here (please read guidance note 3)	Both	
Tue					
Wed			State any seasonal variations for performing plays (please read guidance note 4)		
Thur					
Fri			Non standard timings. Where you intend to use the premises for the performance of plays at different times to those listed in the column on the left, please list (please read guidance note 5)		
Sat					
Sun					

B

Films Standard days and timings (please read guidance note 6)			Will the exhibition of films take place indoors or outdoors or both – please tick [Y] (please read guidance note 2)	Indoors	
				Outdoors	
Day	Start	Finish		Both	
Mon			Please give further details here (please read guidance note 3)		
Tue					
Wed			State any seasonal variations for the exhibition of films (please read guidance note 4)		
Thur					
Fri			Non standard timings. Where you intend to use the premises for the exhibition of films at different times to those listed in the column on the left, please list (please read guidance note 5)		
Sat					
Sun					

C

Indoor sporting events Standard days and timings (please read guidance note 6)			Please give further details (please read guidance note 3)	
Day	Start	Finish		
Mon			State any seasonal variations for indoor sporting events (please read guidance note 4)	
Tue				
Wed				
Thur				Non standard timings. Where you intend to use the premises for indoor sporting events at different times to those listed in the column on the left, please list (please read guidance note 5)
Fri				
Sat				
Sun				

D

Boxing or wrestling entertainments Standard days and timings (please read guidance note 6)			Will the boxing or wrestling entertainment take place indoors or outdoors or both – please tick [Y](please read guidance note 2)	Indoors	
				Outdoors	
Day	Start	Finish		Both	
Mon			Please give further details here (please read guidance note 3)		
Tue					
Wed			State any seasonal variations for boxing or wrestling entertainment (please read guidance note 4)		
Thur					
Fri			Non standard timings. Where you intend to use the premises for boxing or wrestling entertainment at different times to those listed in the column on the left, please list (please read guidance note 5)		
Sat					
Sun					

E

Live music Standard days and timings (please read guidance note 6)			Will the performance of live music take place indoors or outdoors or both – please tick [Y] (please read guidance note 2)	Indoors
Day	Start	Finish		Outdoors
				Both
Mon			Please give further details here (please read guidance note 3)	
Tue				
Wed			State any seasonal variations for the performance of live music (please read guidance note 4)	
Thur				
Fri			Non standard timings. Where you intend to use the premises for the performance of live music at different times to those listed in the column on the left, please list (please read guidance note 5)	
Sat				
Sun				

F

Recorded music Standard days and timings (please read guidance note 6)			Will the playing of recorded music take place indoors or outdoors or both – please tick [Y] (please read guidance note 2)	Indoors	
Day	Start	Finish		Outdoors	
Mon			Please give further details here (please read guidance note 3)	Both	
Tue					
Wed			State any seasonal variations for playing recorded music (please read guidance note 4)		
Thur					
Fri			Non standard timings. Where you intend to use the premises for the playing of recorded music entertainment at different times to those listed in the column on the left, please list (please read guidance note 5)		
Sat					
Sun					

G

Performances of dance Standard days and timings (please read guidance note 6)			Will the performance of dance take place indoors or outdoors or both – please tick [Y] (please read guidance note 2)	Indoors	
Day	Start	Finish		Outdoors	
				Both	
Mon			Please give further details here (please read guidance note 3)		
Tue					
Wed			State any seasonal variations for the performance of dance (please read guidance note 4)		
Thur					
Fri					
Sat			Non standard timings. Where you intend to use the premises for the performance of dance entertainment at different times to those listed in the column on the left, please list (please read guidance note 5)		
Sun					

H

Anything of a similar description to that falling within (e), (f) or (g) Standard days and timings (please read guidance note 6)			Please give a description of the type of entertainment you will be providing		
Day	Start	Finish	Will this entertainment take place indoors or outdoors or both – please tick [Y] (please read guidance note 2)	Indoors	
Mon				Outdoors	
				Both	
Tue			Please give further details here (please read guidance note 3)		
Wed					
Thur					
Fri			State any seasonal variations for entertainment of a similar description to that falling within (e), (f) or (g) (please read guidance note 4)		
Sat					
Sun					
			Non standard timings. Where you intend to use the premises for the entertainment of similar description to that falling within (e), (f) or (g) at different times to those listed in the column on the left, please list (please read guidance note 5)		

APPENDIX B

Provision of facilities for making music Standard days and timings (please read guidance note 6)			Please give a description of the facilities for making music you will be providing		
			Will the facilities for making music be indoors or outdoors or both – please tick [Y] (please read guidance note 2)	Indoors	
				Outdoors	
Day	Start	Finish	Both		
Mon			Please give further details here (please read guidance note 3)		
Tue					
Wed					
Thur			State any seasonal variations for the provision of facilities for making music (please read guidance note 4)		
Fri			Non standard timings. Where you intend to use the premises for provision of facilities for making music entertainment at different times to those listed in the column on the left, please list (please read guidance note 5)		
Sat					
Sun					

APPENDIX B

J

Provision of facilities for dancing Standard days and timings (please read guidance note 6)			Will the facilities for dancing be indoors or outdoors or both – please tick [Y] (see guidance note 2)	Indoors	
Day	Start	Finish		Outdoors	
				Both	
Mon			Please give a description of the facilities for dancing you will be providing		
Tue					
Wed					
Thur					
Fri					
Sat					
Sun					
			Please give further details here (please read guidance note 3)		
			State any seasonal variations for providing dancing facilities (please read guidance note 4)		
			Non standard timings. Where you intend to use the premises for the provision of facilities for dancing entertainment at different times to those listed in the column on the left, please list (please read guidance note 5)		

K

Provision of facilities for entertainment of a similar description to that falling within I or J Standard days and timings (please read guidance note 6)			Please give a description of the type of entertainment facility you will be providing		
Day	Start	Finish	Will the entertainment facility be indoors or outdoors or both – please tick [Y] (please read guidance note 2)	Indoor	
Mon				Outdoor	
				Both	
Tue			Please give further details here (please read guidance note 3)		
Wed					
Thur			State any seasonal variations for the provision of facilities for entertainment of a similar description to that falling within I or J (please read guidance note 4)		
Fri					
Sat			Non standard timings. Where you intend to use the premises for the provision of facilities for entertainment of a similar description to that falling within I or J at different times to those listed in the column on the left, please list (please read guidance note 5)		
Sun					

APPENDIX B

L

Late night refreshment Standard days and timings (please read guidance note 6)			Will the provision of late night refreshment take place indoors or outdoors or both – please tick [Y] (please read guidance note 2)	Indoors	
Day	Start	Finish		Outdoors	
Mon			Please give further details here (please read guidance note 3)	Both	
Tue					
Wed			State any seasonal variations for the provision of late night refreshment (please read guidance note 4)		
Thur					
Fri			Non standard timings. Where you intend to use the premises for the provision of late night refreshment at different times, to those listed in the column on the left, please list (please read guidance note 5)		
Sat					
Sun					

M

Supply of alcohol Standard days and timings (please read guidance note 6)			Will the sale of alcohol be for consumption (Please tick box Y) (please read guidance note 7)	On the premises
Day	Start	Finish		Off the premises <input checked="" type="checkbox"/>
				Both
Mon	9am	9pm	State any seasonal variations for the supply of alcohol (please read guidance note 4)	
Tue	9am	9pm		
Wed	9am	9pm		
Thur	9am	11pm	Non-standard timings. Where you intend to use the premises for the supply of alcohol at different times to those listed in the column on the left, please list (please read guidance note 5)	
Fri	9am	11pm		
Sat	9am	11pm		
Sun	9am	9pm		

APPENDIX B

State the name and details of the individual whom you wish to specify on the licence as premises supervisor

Name..... VIRGINIJA KLYDZIAITE.....

Address..... 48 OUNDLE ROAD.....

..... PETERBOROUGH.....

Postcode..... PE2 9PA.....

Personal Licence number(if known).....

Issuing licensing authority (if known).....

N

Please highlight any adult entertainment or services, activities, other entertainment or matters ancillary to the use of the premises that may give rise to concern in respect of children (please read guidance note 8)

NONE

O

Hours premises are open to the public Standard timings (please read guidance note 6)			State any seasonal variation (please read guidance note 4)
Day	Start	Finish	
Mon	9am	9pm	<p>Non standard timings. Where you intend to use the premises to be open to the public at different times from those listed in the column on the left, please list (please read guidance note 5)</p>
Tue	9am	9pm	
Wed	9am	9pm	
Thur	9am	11pm	
Fri	9am	11pm	
Sat	9am	11pm	
Sun	9am	9pm	

P

Describe the steps you intend to take to promote the four licensing objectives:

- a) **General – all four licensing objectives (b,c,d,e)** (please read guidance note 9)

CLEAR SIGNS WILL BE PLACED AT THE PREMISES CONFIRMING THAT ANY CUSTOMER APPEARING UNDER THE AGE OF 25 WILL BE REQUIRED TO PROVIDE PROOF OF AGE WHEN PURCHASING ALCOHOL.

STAFF WILL BE ADEQUATELY TRAINED IN CUSTOMER RELATIONS TO PREVENT AS FAR AS POSSIBLE INCIDENTS ARISING AND THE ACTION TO BE TAKEN IN DIFFERENT SITUATIONS SUCH AS IN AN EMERGENCY.

APPENDIX B

b) **The prevention of crime and disorder**

THE APPLICANT WILL INSTALL CCTV CAMERAS IN THE PREMISES.

THE APPLICANT WILL REFUSE TO SELL ALCOHOL TO ANYBODY APPEARING TO HIM TO BE UNDER THE EXCESSIVE INFLUENCE OF DRINK OR DRUGS.

THE APPLICANT IS PREPARED TO DISCUSS WITH THE POLICE OR THE OTHER RESPONSIBLE AUTHORITIES ANY OTHER MEASURES THAT THEY CONSIDER PRUDENT TO PREVENT CRIME AND DISORDER.

c) **Public safety**

THE APPLICANT WILL ENSURE THE PROPER MAINTENANCE OF ALL ESCAPE ROUTES AND EXITS.

THE APPLICANT WILL PLACE FIRE ACTION NOTICES IN PROMINENT PLACES AND ENSURE THAT THERE IS A FIRST AID BOX ON THE PREMISES.

THE APPLICANT WILL PLACE A SIGN AT THE EXIT TO THE PREMISES ASKING THAT ANYBODY PURCHASING ALCOHOL DISPOSES OF THEIR BOTTLES/CANS RESPONSIBLY.

THE APPLICANT IS PREPARED TO DISCUSS WITH THE POLICE OR THE OTHER RESPONSIBLE AUTHORITIES ANY OTHER MEASURES THAT THEY CONSIDER PRUDENT TO ENSURE PUBLIC SAFETY.

d) **The prevention of public nuisance**

THE APPLICANT IS PREPARED TO DISCUSS WITH THE POLICE OR THE OTHER RESPONSIBLE AUTHORITIES ANY OTHER MEASURES THAT THEY CONSIDER PRUDENT TO PREVENT A PUBLIC NUISANCE ARISING FROM THE PREMISES.

e) **The protection of children from harm**

THE APPLICANT WILL HAVE A POLICY REQUIRING THE PRODUCTION OF PROOF OF AGE FOR ANY SALE OF ALCOHOL THAT TAKES PLACE WHERE THERE IS A SUSPICION THAT THE CUSTOMER IS UNDER 25 YEARS OF AGE.

APPENDIX B

CHECKLIST:- Please tick ✓ yes

- I have made or enclosed payment of the fee
- I have enclosed the plan of the premises
- I have sent copies of this application and the plan to responsible authorities and others where applicable
- I have enclosed the consent form completed by the individual I wish to be premises supervisor, if applicable
- I understand that I must now advertise my application
- I understand that if I do not comply with the above requirements my application will be rejected

IT IS AN OFFENCE, LIABLE ON CONVICTION TO A FINE UP TO LEVEL 5 ON THE STANDARD SCALE, UNDER SECTION 158 OF THE LICENSING ACT 2003, TO MAKE A FALSE STATEMENT IN OR IN CONNECTION WITH THIS APPLICATION

Part 4 – Signatures (please read guidance note 10)

Signature of applicant or applicant’s solicitor or other duly authorised agent. (See guidance note 11) **If signing on behalf of the applicant please state in what capacity.**

Signature C M Gumbrell

Date 30 April 2014

Capacity Solicitor

For joint applications signature of 2nd applicant or 2nd applicant’s solicitor or other authorised agent. (please read guidance note 12) **If signing on behalf of the applicant please state in what capacity.**

Signature

Date

Capacity

Contact name (where not previously given) and postal address for correspondence associated with this application (please read guidance note 13)	
ROYTHORNES LIMITED	
DEAN’S COURT	
10 MINSTER PRECINCTS	
DX 12311, PETERBOROUGH 1	
(REF. CMG/NC/XHE.1-3)	
Post town	Post code
PETERBOROUGH	PE1 1XS

Telephone number (if any)

01733 558585

If you would prefer us to correspond with you by e-mail your e-mail address (optional)

CAROLINEGUMBRELL@ROYTHORNES.CO.UK

Notes for Guidance

1. Describe the premises. For example the type of premises, its general situation and layout and any other information which could be relevant to the licensing objectives. Where your application includes off-supplies of alcohol and you intend to provide a place for consumption of these off-supplies you must include a description of where the place will be and its proximity to the premises.
2. Where taking place in a building or other structure please tick as appropriate. Indoors may include a tent.
3. For example the type of activity to be authorised, if not already stated, and give relevant further details, for example (but not exclusively) whether or not music will be amplified or unamplified.
4. For example (but not exclusively), where the activity will occur on additional days during the summer months.
5. For example (but not exclusively), where you wish the activity to go on longer on a particular day, e.g. Christmas Eve.
6. Please give timings in 24 hour clock (e.g. 16:00) and only give details for the days of the week when you intend the premises to be used for the activity.
7. If you wish people to be able to consume alcohol on the premises please tick on, if you wish people to be able to purchase alcohol to consume away from the premises please tick off. If you wish people to be able to do both please tick both.
8. Please give information about anything intended to occur at the premises or ancillary to the use of the premises which may give rise to concern in respect of children, regardless of whether you intend children to have access to the premises, for example (but not exclusively) nudity or semi-nudity, films for restricted age groups, the presence of gaming machines.
9. Please list here steps you will take to promote all four licensing objectives together.
10. The application form must be signed.
11. An applicant's agent (for example solicitor) may sign the form on their behalf provided that they have actual authority to do so.
12. Where there is more than one applicant, both applicants or their respective agents must sign the application form.
13. This is the address which we shall use to correspond with you about this application.

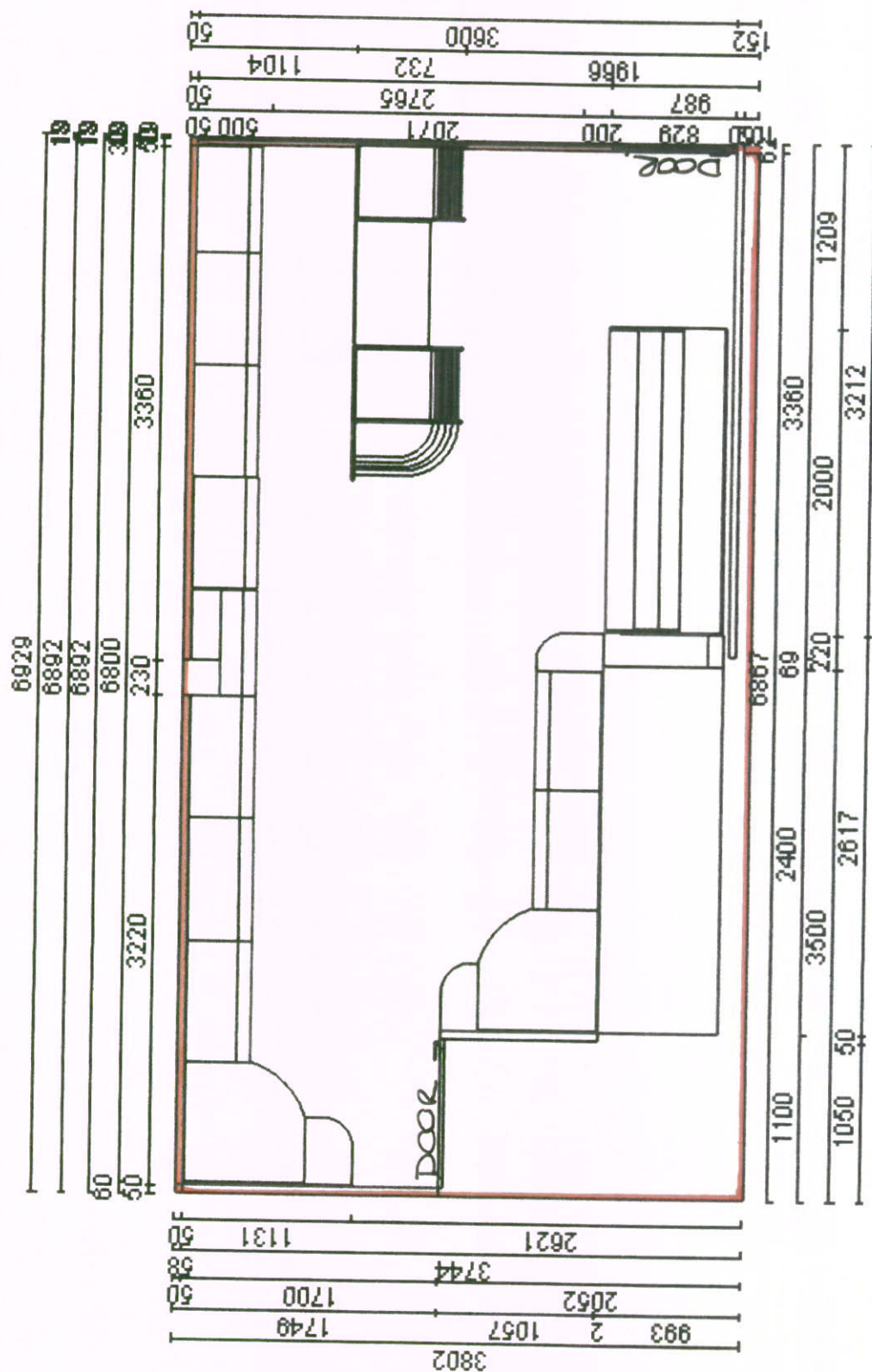

Nr zlecenia:	10/02/2014
Odbiorca:	
Projektant:	
Uwagi:	

This page is intentionally left blank

Turvey Philippa

From: Cllr Thulbourn Nick
Sent: 28 May 2014 15:07
To: Licensing
Subject: 069399

Hi

I have been asked and agreed to call in this application to licensing committee. There is a concern locally that the sale of alcohol has reached saturation in the area. Within a couple of hundred yards there are now well over a dozen places to buy alcohol.

If you could email back confirmation you have received this email.

Elbow is a brief outline of the my and local residents opposition to the granting of this license

1. The prevention of crime and disorder

There has been a lot of work to drive down street drinking and the prevention of crime and disorder in the area. Another outlet selling alcohol will not only send the message but encourage more disorder

2. Public safety

With over a dozen outlets in the immediate vicinity, another would tip the scales over and create an environment that will encourage more drunken behaviour and will help re create an unsafe environment particularly in the nearby children's park.

3. The protection of children from harm

This is a busy retail area, close to a children's park. The risk is to encourage further street drinking in the children's play area and create an environment which is detrimental to business and local shopping. Children will be under severe pressure and their safety will be at risk with saturating the area with alcohol outlets.

4. The prevention of public nuisance

Street drinking has been a real problem in the area and over the last two years this issue has been tackled with a significant amount of success. By allowing saturation this send a message to the people who were a real public nuisance that the message has changed and the mixed message will encourage the significant nuisance issues to return

Many thanks

Cllr Nick Thulbourn
Fletton & Woodston
07990 613473

This page is intentionally left blank

Licencing Authority
Peterborough City Council
Licencing Section
4th Floor Bayard Place
Peterborough
PE1 1HZ

PETERBOROUGH CITY COUNCIL

16 MAY 2014

LICENSING

14 May 2014

Dear Sirs

Premises Licence Application Number: 069399
Mr Adem Xhemajl - 48 Oundle Road, Peterborough. PE2 9PA

We, the undersigned wish to raise our objection to the granting of a Premises Licence for the supply of alcohol from the above address. We believe that the issue of such a licence will contribute to the following issues relating to the licencing objectives; Prevention of crime and disorder, Public safety, Prevention of Public Nuisance, and Protection of children from harm:

1. The sale of alcohol from any more premises will add to the increase in alcohol related problems of street drinking and vandalism.
2. Young people will be further exposed to alcohol and tobacco and find it easier to get hold of such goods, adding to the already existing underage drinking problems and health issues.
3. Adding to the existing 10 – 12 licenced premises within half a mile will have a detrimental effect on the community and the lives of residents.
4. The traffic situation is likely to get worse along Oundle Road. There have been a number of accidents involving motorists, pedestrians and cyclists within the last few years.
5. An increase of licenced shops will lead to undesirable competition, leading to business's cutting their selling prices ridiculously in the face of increased competition, as already seen in Millfield and Eastfield areas of the city.
6. Shopkeepers, being forced to sell at very low prices will most likely be targeted by unscrupulous and illegal suppliers of cheap beer and spirits.

We believe that there are enough licenced premises, both public houses and shops (some selling alcohol 24 hours) in the immediate area to meet the consumer's needs.

Yours faithfully

Khushwant Singh Bhakar (Director)
Bhakar Enterprises Ltd
52-54 Oundle Road
Woodston
PETERBOROUGH
PE2 9PA

Rajesh Sampat
Nisa Local
66-68 Oundle Road
Woodston
PETERBOROUGH
PE2 9PA

**THE LICENSING ACT 2003
REPRESENTATION FORM FOR INTERESTED PERSON / BODY
(living in the 'vicinity' of the premises detailed below)**

Your name / Company name	MARK KAREER
(Name of Body you represent) Please tick one: *	
i) a person living in the vicinity of the premises <input checked="" type="checkbox"/>	ii) a body representing persons who live in that vicinity <input type="checkbox"/>
iii) a person involved in a business in the vicinity of the premises <input type="checkbox"/>	iv) a body representing persons involved in these businesses <input type="checkbox"/>
Postal Address (inc post code)	49A PALMERSTON ROAD, 7/BROUGH
Contact telephone number:	PE2 9DQ
Mobile Number:	
Email address:	

Name of Premises you are making a representation about:	General Store	Application Number: 069399
Address of the premises you are making a representation about:	48 Oundle Road, Peterborough. PE2 9PA PETERBOROUGH CITY COUNCIL 29 MAY 2014	

This section is about your representation/s. They must relate to one or more of the Licensing Objectives. Please detail the evidence supporting your representation, (under the relevant headings) and the reason for your representation/s. (Use additional sheets if necessary) Regulations provide that in considering representations the authority may take into account documentary or othr information produced by the party either before the hearing or, with the consent of all parties, at the hearing.

<p>The prevention of crime and disorder</p> <p>TOO MANY DRUNK PEOPLE WILL EXASPERATE THIS EXISTING PROBLEM!</p>	<p>Public safety</p> <ul style="list-style-type: none"> - INCREASED TRAFFIC IN ALREADY BUSY ROAD. - MORE YOUTHS HANGING AROUND AREA UNDER AGE ASKING EXISTING SHOPPERS TO PURCHASE ALCOHOL FOR THEM.
<p>The prevention of public nuisance</p> <ul style="list-style-type: none"> - ANTI SOCIAL BEHAVOUR ALREADY OCCURING AROUND EXISTING SHOPS. - SMASHING OF BOTTLES, DEPOSITING OF LITTER, LEAD LANGUAGE, SHOUTING, VERBAL ABUSE. - THIS EXISTING NOISE IS DISTURBING THE LOCAL COMMUNITY LIVING IN CLOSE PROXIMITY TO SHOPS, MORE SO THE ELDERLEY RESIDENTS 	<p>The protection of children from harm</p> <ul style="list-style-type: none"> - INCREASED OUTLETS SELLING MORE ALCHOL WILL FURTHER ENHANCE UNDER AGE DRINKING, THEREFORE PRICES MAY BE FORCED EVEN LOWER. - FOR THIS AND ALL OTHER REASONS GIVEN, THE GRANTING OF A LICENCE TO SELL ALCHOL IN THIS SHOP IS NOT NEEDED, AND SHOULD NOT BE ISSUED!

Suggested conditions that could be added to the licence to remedy your representations, or other suggestions you would like the licensing authority to take into account

JUST TO RETIERATE, THAT NO APPLICATION IN THE VICINITY TO SELL ADDITIONAL ALCOHOL BY GRANTED LICENCE SHOULD BE GRANTED! OUR ALREADY LOCAL SERVING SHOPS TO THE COMMUNITY ALREADY MANAGES THIS EFFECTIVELY!

APPENDIX D

The term 'vicinity' is used in the Licensing Act 2003, in particular with reference to those 'interested parties' (see definition in guidance attached) who may lodge objections to applications for premises licences and who may make representations concerning existing premises licences. Unfortunately the Act does not define the term 'vicinity' but the licensing authority will determine each case on its individual merit.

If the licensing authority considers that relevant representations are made the licensing team will consider arranging a mediation meeting between the relevant parties (if all agree) to try and reach a settlement. If this informal process is unsuccessful a hearing before the Licensing Sub Committee will follow, unless the interested parties withdraw their representations.

All representations in their entirety, including your name and address will be disclosed to the applicant for the premises licence and the members of the [Sub]Committee, so that they can make an informal decision on the application.

Signed  Date 28/05/14

MARK KARFER
Please print name

Please return this form along with any additional sheets to:

The Licensing Team
Peterborough City Council
4th Floor Bayard Place
Broadway
Peterborough
PE1 1HZ

Telephone: 01733 453491

Email: eh.licensing@peterborough.gov.uk

This form must be returned within the Statutory Period, which is generally 28 days from the date on which the application was given to the licensing authority by the Applicant.

However, because of the tight timescales involved, and to assist in the determination of the application process, any representations should be forwarded to the licensing authority AS SOON AS POSSIBLE and preferably within 14 days of notification of the application.

If in any doubt, please contact the Licensing Team on the above telephone number.

Public Petition to Block the granting of Premises Licence Application Number: 069399

<p>Petition summary and background</p>	<p>Premises Licence Application Number: 069399 Mr. Adem Xhemail - 48 Oundle Road, Peterborough. PE2 9PA</p>
<p>Action petitioned for</p>	<p>We, the undersigned, are concerned citizens, wish to raise our objection to the granting of a Premises Licence for the supply of alcohol from the above address. We believe that the issue of such a licence will contribute to the following issues and urge our council representatives to act now.</p> <ol style="list-style-type: none"> 1. The sale of alcohol from any more premises will add to the increase in alcohol related problems of street drinking and vandalism. 2. Young people will be further exposed to alcohol and tobacco and find it easier to get hold of such goods, adding to the already existing underage drinking problems and health issues. 3. Adding to the existing 10 – 12 licenced premises within half a mile will have a detrimental effect on the community and the lives of residents. 4. The traffic situation is likely to get worse along Oundle Road. There have been a number of accidents involving motorists, pedestrians and cyclists within the last few years. 5. An increase of licenced shops will lead to undesirable competition, leading to business's cutting their selling prices ridiculously in the face of increased competition, as already seen in Milfield and Eastfield areas of the city. 6. Shopkeepers, being forced to sell at very low prices will most likely be targeted by unscrupulous and illegal suppliers of cheap beer and spirits. <p>We believe that there are enough licenced premises, both public houses and shops (some selling alcohol 24 hours) in the immediate area to meet the consumer's needs.</p>

PETERBOROUGH CITY COUNCIL

23 MAY 2014

LICENSING

Printed Name	Signature	Address	Comment	Date
Nadje Kilham	m kilham	14 WRAF ROAD P'BORE.	Already too many shops here.	16/05/14
FRANC GILLU	F Gillu	82 NEW RD P'BORE	Too many shops licenses	16/05/14
JAYLANA FIELD	JGF	171 BEEBEE AVE	Too Many shops already	16/5/14
* FLOYD Mc HINER	F M	10 EARLINGTON	about want it	16/5/14
HELEN WATSON	H Watson	45 PALMERSTON ROAD	too many licenses shops ALREADY.	16/5/14
WARRREN (KAWPOND)	W Warren	34 Palmerston Road	TO many shops	16.5.14
MADE LEICERS	M Leic	19 BUNNIE ROAD	TO MANY LICENSES	16.5.14
* JANE STELSON	J Stelson	APPEL ST L'BORE	-dr-	16/5/14
RUTH STOKS	R Stoks	32 George streets	- " -	16/5/14
P. CHAPPELL	P. Chappell	38 TUBEEE ST	Too many Licence Shops	16/5/14
KAN SHARR	K Sharr	36 TOWER ST	"	16/5/14
CSMRS DUKY	C S C S	36 Albany WTK	"	16/5/14
ANDY COLE	A Cole	22 PALMERSTONE ROAD	"	16/5/14
R GALLOWAY	R Galloway	69 SILVER STREET. WOODSTON	"	16/5/14
J. Poohey	John Poohey	28a Oundle Road	Keep local business!!	16/5/14
* M. KAREEK	M Kareek		"	16/5/14

ADONERS UNCLEAN

ADONERS UNCLEAN

No ADDRESSES.

APPENDIX D

Licensing – Alcohol and Entertainment
Growth and Regeneration
Bayard Place
Broadway
Peterborough
PE1

STEVEN WAKE
26A OUNDLE ROAD
PER 9PA,

Reference No: 069399
General Store, 48 Oundle Road
28th May 2014

Dear Sir/ madam

I am writing to you with regards to the application for a licence to sell alcohol on the premises by the above company. As a resident of Woodston I am requesting that the license is not granted to the above for the following reasons:

1) The prevention of crime and disorder

The residents believe granting a license to sell alcohol in this residential area could bring more street drinking to our area. Our local councillor has been working closely with the police to stop this in our area and another alcohol outlet will reverse the gains that have been made. With street drinking there is a greater risk of crime and disorder. There have been a number of incidents in this direct area where police have had to intervene due to alcohol related incidents, which if this license is granted, creates real and significant rises in crime and disorder.

2) Public safety

The above which is located next to 2 retail outlets which already sell alcohol plus new tesco express selling alcohol nearby. There already are 4 entertainment outlets in close vicinity to this retail outlet selling alcohol, Cherry Tree Pub, New Inn Pub, Ebeneezers and the South Grove Community Centre. If people are buying alcohol from this shop and street drinking, with street drinking usually comes public disorder and maybe even violence. There has been violent, drink related problems in the area where people have felt physically threatened or have been the victim of violence. There has been a lot of good work to remove this problem and if this license is granted this work would be put into reverse.

3) The protection of children from harm

This retail business is in a vicinity very close to a Baptist Church and a community centre. The parents and children have to pass by this shop to go to and from the primary schools and nursery. If alcohol is sold here, street drinking will occur as it has happened in the past next to the other two shops which already have a license. Residents feel that if you grant this shop a license to sell alcohol you would be putting our children at risk as with street drinking usually comes public disorder and maybe even violence next to a Church and community centre which are used by local residents with children.

4) The prevention of public nuisance

There are already 2 shops close by which sell alcohol. Street drinking has been a problem in this area for quite some time. If another shop is allowed to sell alcohol the street drinking issue will escalate and with that comes a public nuisance. This would not be fair on the residents who live close by. If the shop sells alcohol it will attract people who will create more noise and disturbance to the residents. The retail outlets who presently sell alcohol have been there for many years and are responsible retailers as they understand the feelings of local residents, in fact they try to discouraged street drinking, this license will encourage more street drinking in an area next to a regularly used Baptist Church and Community Centre where there are already a number of outlets selling alcohol.

Yours faithfully



APPENDIX D

Licensing – Alcohol and Entertainment
Growth and Regeneration
Bayard Place
Broadway
Peterborough
PE1

Reference No: 069399
General Store, 48 Oundle Road
28th May 2014

Mrs H. Tilley
24 George St
PE2 9PD.

Dear Sir/ madam

I am writing to you with regards to the application for a licence to sell alcohol on the premises by the above company. As a resident of Woodston I am requesting that the license is not granted to the above for the following reasons:

1) The prevention of crime and disorder

The residents believe granting a license to sell alcohol in this residential area could bring more street drinking to our area. Our local councillor has been working closely with the police to stop this in our area and another alcohol outlet will reverse the gains that have been made. With street drinking there is a greater risk of crime and disorder. There have been a number of incidents in this direct area where police have had to intervene due to alcohol related incidents, which if this license is granted, creates real and significant rises in crime and disorder.

2) Public safety

The above which is located next to 2 retail outlets which already sell alcohol plus new tesco express selling alcohol nearby. There already are 4 entertainment outlets in close vicinity to this retail outlet selling alcohol, Cherry Tree Pub, New Inn Pub, Ebenezers and the South Grove Community Centre. If people are buying alcohol from this shop and street drinking, with street drinking usually comes public disorder and maybe even violence. There has been violent, drink related problems in the area where people have felt physically threatened or have been the victim of violence. There has been a lot of good work to remove this problem and if this license is granted this work would be put into reverse.

3) The protection of children from harm

This retail business is in a vicinity very close to a Baptist Church and a community centre. The parents and children have to pass by this shop to go to and from the primary schools and nursery. If alcohol is sold here, street drinking will occur as it has happened in the past next to the other two shops which already have a license. Residents feel that if you grant this shop a license to sell alcohol you would be putting our children at risk as with street drinking usually comes public disorder and maybe even violence next to a Church and community centre which are used by local residents with children.

4) The prevention of public nuisance

There are already 2 shops close by which sell alcohol. Street drinking has been a problem in this area for quite some time. If another shop is allowed to sell alcohol the street drinking issue will escalate and with that comes a public nuisance. This would not be fair on the residents who live close by. If the shop sells alcohol it will attract people who will create more noise and disturbance to the residents. The retail outlets who presently sell alcohol have been there for many years and are responsible retailers as they understand the feelings of local residents, in fact they try to discouraged street drinking, this license will encourage more street drinking in an area next to a regularly used Baptist Church and Community Centre where there are already a number of outlets selling alcohol.

Yours faithfully

H. M'Glashan

APPENDIX D

Licensing – Alcohol and Entertainment
Growth and Regeneration
Bayard Place
Broadway
Peterborough
PE1

VGADIMIR
22 EARL SPEINGER COURT
PE2 9PQ

Reference No: 069399
General Store, 48 Oundle Road
28th May 2014

Dear Sir/ madam

I am writing to you with regards to the application for a licence to sell alcohol on the premises by the above company. As a resident of Woodston I am requesting that the license is not granted to the above for the following reasons:

1) The prevention of crime and disorder

The residents believe granting a license to sell alcohol in this residential area could bring more street drinking to our area. Our local councillor has been working closely with the police to stop this in our area and another alcohol outlet will reverse the gains that have been made. With street drinking there is a greater risk of crime and disorder. There have been a number of incidents in this direct area where police have had to intervene due to alcohol related incidents, which if this license is granted, creates real and significant rises in crime and disorder.

2) Public safety

The above which is located next to 2 retail outlets which already sell alcohol plus new tesco express selling alcohol nearby. There already are 4 entertainment outlets in close vicinity to this retail outlet selling alcohol, Cherry Tree Pub, New Inn Pub, Ebenezers and the South Grove Community Centre. If people are buying alcohol from this shop and street drinking, with street drinking usually comes public disorder and maybe even violence. There has been violent, drink related problems in the area where people have felt physically threatened or have been the victim of violence. There has been a lot of good work to remove this problem and if this license is granted this work would be put into reverse.

3) The protection of children from harm

This retail business is in a vicinity very close to a Baptist Church and a community centre. The parents and children have to pass by this shop to go to and from the primary schools and nursery. If alcohol is sold here, street drinking will occur as it has happened in the past next to the other two shops which already have a license. Residents feel that if you grant this shop a license to sell alcohol you would be putting our children at risk as with street drinking usually comes public disorder and maybe even violence next to a Church and community centre which are used by local residents with children.

4) The prevention of public nuisance

There are already 2 shops close by which sell alcohol. Street drinking has been a problem in this area for quite some time. If another shop is allowed to sell alcohol the street drinking issue will escalate and with that comes a public nuisance. This would not be fair on the residents who live close by. If the shop sells alcohol it will attract people who will create more noise and disturbance to the residents. The retail outlets who presently sell alcohol have been there for many years and are responsible retailers as they understand the feelings of local residents, in fact they try to discouraged street drinking, this license will encourage more street drinking in an area next to a regularly used Baptist Church and Community Centre where there are already a number of outlets selling alcohol.

Yours faithfully

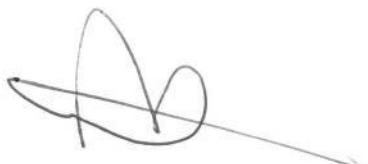

APPENDIX D

Licensing – Alcohol and Entertainment
Growth and Regeneration
Bayard Place
Broadway
Peterborough
PE1

Darren Panken

Reference No: 069399
General Store, 48 Oundle Road
28th May 2014

Dear Sir/ madam

I am writing to you with regards to the application for a licence to sell alcohol on the premises by the above company. As a resident of Woodston I am requesting that the license is not granted to the above for the following reasons:

1) The prevention of crime and disorder

The residents believe granting a license to sell alcohol in this residential area could bring more street drinking to our area. Our local councillor has been working closely with the police to stop this in our area and another alcohol outlet will reverse the gains that have been made. With street drinking there is a greater risk of crime and disorder. There have been a number of incidents in this direct area where police have had to intervene due to alcohol related incidents, which if this license is granted, creates real and significant rises in crime and disorder.

2) Public safety

The above which is located next to 2 retail outlets which already sell alcohol plus new tesco express selling alcohol nearby. There already are 4 entertainment outlets in close vicinity to this retail outlet selling alcohol, Cherry Tree Pub, New Inn Pub, Ebenezers and the South Grove Community Centre. If people are buying alcohol from this shop and street drinking, with street drinking usually comes public disorder and maybe even violence. There has been violent, drink related problems in the area where people have felt physically threatened or have been the victim of violence. There has been a lot of good work to remove this problem and if this license is granted this work would be put into reverse.

and
Swiss Cottage
Public
House

3) The protection of children from harm

This retail business is in a vicinity very close to a Baptist Church and a community centre. The parents and children have to pass by this shop to go to and from the primary schools and nursery. If alcohol is sold here, street drinking will occur as it has happened in the past next to the other two shops which already have a license. Residents feel that if you grant this shop a license to sell alcohol you would be putting our children at risk as with street drinking usually comes public disorder and maybe even violence next to a Church and community centre which are used by local residents with children.

4) The prevention of public nuisance

There are already 2 shops close by which sell alcohol. Street drinking has been a problem in this area for quite some time. If another shop is allowed to sell alcohol the street drinking issue will escalate and with that comes a public nuisance. This would not be fair on the residents who live close by. If the shop sells alcohol it will attract people who will create more noise and disturbance to the residents. The retail outlets who presently sell alcohol have been there for many years and are responsible retailers as they understand the feelings of local residents, in fact they try to discouraged street drinking, this license will encourage more street drinking in an area next to a regularly used Baptist Church and Community Centre where there are already a number of outlets selling alcohol.

Yours faithfully



Room 10 Fairview Court
Oundle road Woodston

APPENDIX D

Licensing – Alcohol and Entertainment
Growth and Regeneration
Bayard Place
Broadway
Peterborough
PE1

Cherry
34 Nible ST

Reference No: 069399
General Store, 48 Oundle Road
28th May 2014

Dear Sir/ madam

I am writing to you with regards to the application for a licence to sell alcohol on the premises by the above company. As a resident of Woodston I am requesting that the license is not granted to the above for the following reasons:

1) The prevention of crime and disorder

The residents believe granting a license to sell alcohol in this residential area could bring more street drinking to our area. Our local councillor has been working closely with the police to stop this in our area and another alcohol outlet will reverse the gains that have been made. With street drinking there is a greater risk of crime and disorder. There have been a number of incidents in this direct area where police have had to intervene due to alcohol related incidents, which if this license is granted, creates real and significant rises in crime and disorder.

2) Public safety

The above which is located next to 2 retail outlets which already sell alcohol plus new tesco express selling alcohol nearby. There already are 4 entertainment outlets in close vicinity to this retail outlet selling alcohol, Cherry Tree Pub, New Inn Pub, Ebenezers and the South Grove Community Centre. If people are buying alcohol from this shop and street drinking, with street drinking usually comes public disorder and maybe even violence. There has been violent, drink related problems in the area where people have felt physically threatened or have been the victim of violence. There has been a lot of good work to remove this problem and if this license is granted this work would be put into reverse.

3) The protection of children from harm

This retail business is in a vicinity very close to a Baptist Church and a community centre. The parents and children have to pass by this shop to go to and from the primary schools and nursery. If alcohol is sold here, street drinking will occur as it has happened in the past next to the other two shops which already have a license. Residents feel that if you grant this shop a license to sell alcohol you would be putting our children at risk as with street drinking usually comes public disorder and maybe even violence next to a Church and community centre which are used by local residents with children.

4) The prevention of public nuisance

There are already 2 shops close by which sell alcohol. Street drinking has been a problem in this area for quite some time. If another shop is allowed to sell alcohol the street drinking issue will escalate and with that comes a public nuisance. This would not be fair on the residents who live close by. If the shop sells alcohol it will attract people who will create more noise and disturbance to the residents. The retail outlets who presently sell alcohol have been there for many years and are responsible retailers as they understand the feelings of local residents, in fact they try to discouraged street drinking, this license will encourage more street drinking in an area next to a regularly used Baptist Church and Community Centre where there are already a number of outlets selling alcohol.

Yours faithfully



THE LICENSING ACT 2003
REPRESENTATION FORM FOR INTERESTED PERSON / BODY
(living in the 'vicinity' of the premises detailed below)

Your name / Company name	MRS. H.A. CREED
(Name of Body you represent) Please tick one: • i) a person living in the vicinity of the premises <input checked="" type="checkbox"/> ii) a body representing persons who live in that vicinity <input type="checkbox"/> iii) a person involved in a business in the vicinity of the premises <input type="checkbox"/> iv) a body representing persons involved in these businesses <input type="checkbox"/>	
Postal Address (inc post code)	29 SILVER ST 1 PETERBOROUGH
Contact telephone number:	[REDACTED]
Mobile Number:	-
Email address:	-

PETERBOROUGH CITY COUNCIL
29 MAY 2014
LICENSING

Name of Premises you are making a representation about:	General Store Application Number: 069399
Address of the premises you are making a representation about:	48 Oundle Road, Peterborough. PE2 9PA

This section is about your representation/s. They must relate to one or more of the Licensing Objectives. Please detail the evidence supporting your representation, (under the relevant headings) and the reason for your representation/s. (Use additional sheets if necessary) Regulations provide that in considering representations the authority may take into account documentary or othr information produced by the party either before the hearing or, with the consent of all parties, at the hearing.

The prevention of crime and disorder There is already a surplus of licenced retailers in the area, especially since Tescos recently opened an express store.	Public safety As well as cans and bottles littering the streets as a single woman, it's quite intimidating to walk around when dealt with people drinkey/drank in the streets
The prevention of public nuisance An outlet of this nature, I believe would attract a greater number of undesirable characters and would undoubtedly increase the crime rate in the area.	The protection of children from harm There are children's play areas and schools nearby. There could be danger from drunken people and also broken bottles.

Suggested conditions that could be added to the licence to remedy your representations, or other suggestions you would like the licensing authority to take into account

We do not need another off licence selling cheap alcohol - the community would be better served by a chemist/pharmacy which is non-existent in the area.

APPENDIX D

The term 'vicinity' is used in the Licensing Act 2003, in particular with reference to those 'interested parties' (see definition in guidance attached) who may lodge objections to applications for premises licences and who may make representations concerning existing premises licences. Unfortunately the Act does not define the term 'vicinity' but the licensing authority will determine each case on its individual merit.

If the licensing authority considers that relevant representations are made the licensing team will consider arranging a mediation meeting between the relevant parties (if all agree) to try and reach a settlement. If this informal process is unsuccessful a hearing before the Licensing Sub Committee will follow, unless the interested parties withdraw their representations.

All representations in their entirety, including your name and address will be disclosed to the applicant for the premises licence and the members of the [Sub]Committee, so that they can make an informal decision on the application.

Signed *L.A. Creed* Date 28/5/14

..... MRS L.A. CREED

Please print name

Please return this form along with any additional sheets to:

The Licensing Team
Peterborough City Council
4th Floor Bayard Place
Broadway
Peterborough
PE1 1HZ

Telephone: 01733 453491

Email: eh.licensing@peterborough.gov.uk

This form must be returned within the Statutory Period, which is generally 28 days from the date on which the application was given to the licensing authority by the Applicant.

However, because of the tight timescales involved, and to assist in the determination of the application process, any representations should be forwarded to the licensing authority AS SOON AS POSSIBLE and preferably within 14 days of notification of the application.

If in any doubt, please contact the Licensing Team on the above telephone number.

Licensing – Alcohol and Entertainment
Growth and Regeneration
Bayard Place
Broadway
Peterborough
PE1

Reference No: 069399
General Store, 48 Oundle Road
28th May 2014

PETERBOROUGH CITY COUNCIL

29 MAY 2014

LICENSING

MRS L. CROFT
29 SILVER ST
WOODSTON
PETERBOROUGH
PE2 9BU

Dear Sir/ madam

I am writing to you with regards to the application for a licence to sell alcohol on the premises by the above company. As a resident of Woodston I am requesting that the license is not granted to the above for the following reasons:

1) The prevention of crime and disorder

The residents believe granting a license to sell alcohol in this residential area could bring more street drinking to our area. Our local councillor has been working closely with the police to stop this in our area and another alcohol outlet will reverse the gains that have been made. With street drinking there is a greater risk of crime and disorder. There have been a number of incidents in this direct area where police have had to intervene due to alcohol related incidents, which if this license is granted, creates real and significant rises in crime and disorder.

2) Public safety

The above which is located next to 2 retail outlets which already sell alcohol plus new tesco express selling alcohol nearby. There already are 4 entertainment outlets in close vicinity to this retail outlet selling alcohol, Cherry Tree Pub, New Inn Pub, Ebeneezers and the South Grove Community Centre. If people are buying alcohol from this shop and street drinking, with street drinking usually comes public disorder and maybe even violence. There has been violent, drink related problems in the area where people have felt physically threatened or have been the victim of violence. There has been a lot of good work to remove this problem and if this license is granted this work would be put into reverse.

3) The protection of children from harm

This retail business is in a vicinity very close to a Baptist Church and a community centre. The parents and children have to pass by this shop to go to and from the primary schools and nursery. If alcohol is sold here, street drinking will occur as it has happened in the past next to the other two shops which already have a license. Residents feel that if you grant this shop a license to sell alcohol you would be putting our children at risk as with street drinking usually comes public disorder and maybe even violence next to a Church and community centre which are used by local residents with children.

4) The prevention of public nuisance

There are already 2 shops close by which sell alcohol. Street drinking has been a problem in this area for quite some time. If another shop is allowed to sell alcohol the street drinking issue will escalate and with that comes a public nuisance. This would not be fair on the residents who live close by. If the shop sells alcohol it will attract people who will create more noise and disturbance to the residents. The retail outlets who presently sell alcohol have been there for many years and are responsible retailers as they understand the feelings of local residents, in fact they try to discouraged street drinking, this license will encourage more street drinking in an area next to a regularly used Baptist Church and Community Centre where there are already a number of outlets selling alcohol.

Yours faithfully



**THE LICENSING ACT 2003
REPRESENTATION FORM FOR INTERESTED PERSON / BODY
(living in the 'vicinity' of the premises detailed below)**

Your name / Company name	Mrs P. A. Lavender
(Name of Body you represent) Please tick one: • i) a person living in the vicinity of the premises <input checked="" type="checkbox"/> ii) a body representing persons who live in that vicinity <input type="checkbox"/> iii) a person involved in a business in the vicinity of the premises <input type="checkbox"/> iv) a body representing persons involved in these businesses <input type="checkbox"/>	
Postal Address (inc post code)	41 Tower St Peterborough PE2 9AE
Contact telephone number:	<input type="text"/>
Mobile Number:	
Email address:	

29 MAY 2014

LICENSING

Name of Premises you are making a representation about:	General Store Application Number: 069399
Address of the premises you are making a representation about:	48 Oundle Road, Peterborough. PE2 9PA

This section is about your representation/s. They must relate to one or more of the Licensing Objectives. Please detail the evidence supporting your representation, (under the relevant headings) and the reason for your representation/s. (Use additional sheets if necessary) Regulations provide that in considering representations the authority may take into account documentary or other information produced by the party either before the hearing or, with the consent of all parties, at the hearing.

The prevention of crime and disorder We do <u>not</u> need another licensed outlet in this area. The present shops and Tesco are more than adequate.	Public safety Just look at the cans and broken bottles already scattered on Bread Street and even on Tower Street & Grove Street.
The prevention of public nuisance Hasn't <u>anything</u> been learned about the wretched state of the Millfield area? It is completely devastated by cheap drink shops.	The protection of children from harm More broken glass
Suggested conditions that could be added to the licence to remedy your representations, or other suggestions you would like the licensing authority to take into account Soft drinks only to be sold.	

APPENDIX D

The term 'vicinity' is used in the Licensing Act 2003, in particular with reference to those 'interested parties' (see definition in guidance attached) who may lodge objections to applications for premises licences and who may make representations concerning existing premises licences. Unfortunately the Act does not define the term 'vicinity' but the licensing authority will determine each case on its individual merit.

If the licensing authority considers that relevant representations are made the licensing team will consider arranging a mediation meeting between the relevant parties (if all agree) to try and reach a settlement. If this informal process is unsuccessful a hearing before the Licensing Sub Committee will follow, unless the interested parties withdraw their representations.

All representations in their entirety, including your name and address will be disclosed to the applicant for the premises licence and the members of the [Sub]Committee, so that they can make an informal decision on the application.

Signed P. A. Lavender Date 28 May 2014

P. A. LAVENDER
Please print name

Please return this form along with any additional sheets to:

The Licensing Team
Peterborough City Council
4th Floor Bayard Place
Broadway
Peterborough
PE1 1HZ

Telephone: 01733 453491

Email: eh.licensing@peterborough.gov.uk

This form must be returned within the Statutory Period, which is generally 28 days from the date on which the application was given to the licensing authority by the Applicant.

However, because of the tight timescales involved, and to assist in the determination of the application process, any representations should be forwarded to the licensing authority AS SOON AS POSSIBLE and preferably within 14 days of notification of the application.

If in any doubt, please contact the Licensing Team on the above telephone number.

PART B

Licensing – Alcohol and Entertainment
Growth and Regeneration
Bayard Place
Broadway
Peterborough
PE1

Mrs R. Lavender
41 Tower St
P'boro
PE2 9AE

Reference No: 069399
General Store, 48 Oundle Road
28th May 2014

[Redacted]

Dear Sir/ madam

I am writing to you with regards to the application for a licence to sell alcohol on the premises by the above company. As a resident of Woodston I am requesting that the license is not granted to the above for the following reasons:

1) The prevention of crime and disorder

The residents believe granting a license to sell alcohol in this residential area could bring more street drinking to our area. Our local councillor has been working closely with the police to stop this in our area and another alcohol outlet will reverse the gains that have been made. With street drinking there is a greater risk of crime and disorder. There have been a number of incidents in this direct area where police have had to intervene due to alcohol related incidents, which if this license is granted, creates real and significant rises in crime and disorder.

2) Public safety

The above which is located next to 2 retail outlets which already sell alcohol plus new tesco express selling alcohol nearby. There already are 4 entertainment outlets in close vicinity to this retail outlet selling alcohol, Cherry Tree Pub, New Inn Pub, Ebeneezers and the South Grove Community Centre. If people are buying alcohol from this shop and street drinking, with street drinking usually comes public disorder and maybe even violence. There has been violent, drink related problems in the area where people have felt physically threatened or have been the victim of violence. There has been a lot of good work to remove this problem and if this license is granted this work would be put into reverse.

3) The protection of children from harm

This retail business is in a vicinity very close to a Baptist Church and a community centre. The parents and children have to pass by this shop to go to and from the primary schools and nursery. If alcohol is sold here, street drinking will occur as it has happened in the past next to the other two shops which already have a license. Residents feel that if you grant this shop a license to sell alcohol you would be putting our children at risk as with street drinking usually comes public disorder and maybe even violence next to a Church and community centre which are used by local residents with children.

4) The prevention of public nuisance

There are already 2 shops close by which sell alcohol. Street drinking has been a problem in this area for quite some time. If another shop is allowed to sell alcohol the street drinking issue will escalate and with that comes a public nuisance. This would not be fair on the residents who live close by. If the shop sells alcohol it will attract people who will create more noise and disturbance to the residents. The retail outlets who presently sell alcohol have been there for many years and are responsible retailers as they understand the feelings of local residents, in fact they try to discourage street drinking, this license will encourage more street drinking in an area next to a regularly used Baptist Church and Community Centre where there are already a number of outlets selling alcohol.

Yours faithfully

R. Lavender

REPRESENTATION FORM FOR INTERESTED PERSON / BODY

(living in the 'vicinity' of the premises detailed below)

23 MAY 2014

(4)

Your name / Company name LICENSING	WOODSTON CHIPPY
(Name of Body you represent) Please tick one: *	
i) a person living in the vicinity of the premises <input type="checkbox"/> ii) a body representing persons who live in that vicinity <input type="checkbox"/>	
iii) a person involved in a business in the vicinity of the premises <input type="checkbox"/> iv) a body representing persons involved in these businesses <input checked="" type="checkbox"/>	
Postal Address (inc post code)	56 OUNDLE RD, PE2 9PA
Contact telephone number:	<input type="text"/>
Mobile Number:	
Email address:	

Name of Premises you are making a representation about:	General Store Application Number: 069399
Address of the premises you are making a representation about:	48 Oundle Road, Peterborough. PE2 9PA

This section is about your representation/s. They must relate to one or more of the Licensing Objectives. Please detail the evidence supporting your representation, (under the relevant headings) and the reason for your representation/s. (Use additional sheets if necessary) Regulations provide that in considering representations the authority may take into account documentary or othr information produced by the party either before the hearing or, with the consent of all parties, at the hearing.

The prevention of crime and disorder There are already too many establishments in the small area serving and selling alcohol leading to increased levels of drunken members of the public.	Public safety <input checked="" type="checkbox"/>
The prevention of public nuisance The streets are littered enough with empty cans / bottles (broken) It is not only dangerous but puts others off the area.	The protection of children from harm <input checked="" type="checkbox"/>

Suggested conditions that could be added to the licence to remedy your representations, or other suggestions you would like the licensing authority to take into account

We do not want Woodston to become another 'Lincoln Road' with an alcohol retailer every few yards and litter everywhere. You do not feel safe.

APPENDIX D

The term 'vicinity' is used in the Licensing Act 2003, in particular with reference to those 'interested parties' (see definition in guidance attached) who may lodge objections to applications for premises licences and who may make representations concerning existing premises licences. Unfortunately the Act does not define the term 'vicinity' but the licensing authority will determine each case on its individual merit.

If the licensing authority considers that relevant representations are made the licensing team will consider arranging a mediation meeting between the relevant parties (if all agree) to try and reach a settlement. If this informal process is unsuccessful a hearing before the Licensing Sub Committee will follow, unless the interested parties withdraw their representations.

All representations in their entirety, including your name and address will be disclosed to the applicant for the premises licence and the members of the [Sub]Committee, so that they can make an informal decision on the application.

Signed  Date 23rd May 2014,
..... L. YAU
Please print name

Please return this form along with any additional sheets to:

The Licensing Team
Peterborough City Council
4th Floor Bayard Place
Broadway
Peterborough
PE1 1HZ

Telephone: 01733 453491

Email: eh.licensing@peterborough.gov.uk

This form must be returned within the Statutory Period, which is generally 28 days from the date on which the application was given to the licensing authority by the Applicant.

However, because of the tight timescales involved, and to assist in the determination of the application process, any representations should be forwarded to the licensing authority AS SOON AS POSSIBLE and preferably within 14 days of notification of the application.

If in any doubt, please contact the Licensing Team on the above telephone number.

APPENDIX D
THE LICENSING ACT 2003

REPRESENTATION FORM FOR INTERESTED PERSON / BODY

23 MAY 2014 (living in the 'vicinity' of the premises detailed below)

3

LICENSING

Your name / Company name	KATIE BARNES
(Name of Body you represent) Please tick one: •	
i) a person living in the vicinity of the premises <input checked="" type="checkbox"/> ii) a body representing persons who live in that vicinity <input type="checkbox"/>	
iii) a person involved in a business in the vicinity of the premises <input type="checkbox"/> iv) a body representing persons involved in these businesses <input checked="" type="checkbox"/>	
Postal Address (inc post code)	PE2 9JA
Contact telephone number:	
Mobile Number:	
Email address:	

Name of Premises you are making a representation about:	General Store Application Number: 069399
Address of the premises you are making a representation about:	48 Oundle Road, Peterborough. PE2 9PA

This section is about your representation/s. They must relate to one or more of the Licensing Objectives. Please detail the evidence supporting your representation, (under the relevant headings) and the reason for your representation/s. (Use additional sheets if necessary) Regulations provide that in considering representations the authority may take into account documentary or othr information produced by the party either before the hearing or, with the consent of all parties, at the hearing.

The prevention of crime and disorder AS THERE ALREADY A VAST NUMBER OF LICENSED PREMISES WITHIN THE VICINITY, I DONT SEE THE NEED TO ALLOW ANOTHER ONE. IT WILL ENTICE THE WRONG CLIENTEL ALONG THE STREET NEXT TO THE SHOP I VOLUNTEER AT.	Public safety
--	---------------

The prevention of public nuisance	The protection of children from harm I VISIT THE SHOP. I VOLUNTEER IN. ON MY DAY OFF WITH MY YOUNG SON. I WOULDN'T FEEL COMFORTABLE WALKING PAST IF IT WAS GRANTED PERMISSION TO SELL ALCOHOL.
-----------------------------------	---

Suggested conditions that could be added to the licence to remedy your representations, or other suggestions you would like the licensing authority to take into account

APPENDIX D

The term 'vicinity' is used in the Licensing Act 2003, in particular with reference to those 'interested parties' (see definition in guidance attached) who may lodge objections to applications for premises licences and who may make representations concerning existing premises licences. Unfortunately the Act does not define the term 'vicinity' but the licensing authority will determine each case on its individual merit.

If the licensing authority considers that relevant representations are made the licensing team will consider arranging a mediation meeting between the relevant parties (if all agree) to try and reach a settlement. If this informal process is unsuccessful a hearing before the Licensing Sub Committee will follow, unless the interested parties withdraw their representations.

All representations in their entirety, including your name and address will be disclosed to the applicant for the premises licence and the members of the [Sub]Committee, so that they can make an informal decision on the application.

Signed  Date 23/5/14

..... KATIE BARNES
Please print name

Please return this form along with any additional sheets to:

The Licensing Team
Peterborough City Council
4th Floor Bayard Place
Broadway
Peterborough
PE1 1HZ

Telephone: 01733 453491

Email: eh.licensing@peterborough.gov.uk

This form must be returned within the Statutory Period, which is generally 28 days from the date on which the application was given to the licensing authority by the Applicant.

However, because of the tight timescales involved, and to assist in the determination of the application process, any representations should be forwarded to the licensing authority AS SOON AS POSSIBLE and preferably within 14 days of notification of the application.

If in any doubt, please contact the Licensing Team on the above telephone number.

**THE LICENSING ACT 2003
REPRESENTATION FORM FOR INTERESTED PERSON / BODY
(living in the 'vicinity' of the premises detailed below)**

Your name / Company name	HELEN ES. OWEN
(Name of Body you represent) Please tick one: • i) a person living in the vicinity of the premises <input checked="" type="checkbox"/> ii) a body representing persons who live in that vicinity <input type="checkbox"/> iii) a person involved in a business in the vicinity of the premises <input type="checkbox"/> iv) a body representing persons involved in these businesses <input type="checkbox"/>	
Postal Address (inc post code)	6 GROVER ST WOODSTON PE29AG
Contact telephone number:	
Mobile Number:	
Email address:	

Name of Premises you are making a representation about:	General Store Application Number: 069399
Address of the premises you are making a representation about:	48 Oundle Road, Peterborough. PE2 9PA

This section is about your representation/s. They must relate to one or more of the Licensing Objectives. Please detail the evidence supporting your representation, (under the relevant headings) and the reason for your representation/s. (Use additional sheets if necessary) Regulations provide that in considering representations the authority may take into account documentary or othr information produced by the party either before the hearing or, with the consent of all parties, at the hearing.

The prevention of crime and disorder	Public safety
don't want to add to the trouble caused by alcohol	old people feel afraid to go out at night
The prevention of public nuisance	The protection of children from harm
enough trouble with drunks in the street at present	increase underage drinking Broken glass left by drunks hurts Dogs & kids

Suggested conditions that could be added to the licence to remedy your representations, or other suggestions you would like the licensing authority to take into account



APPENDIX D

The term 'vicinity' is used in the Licensing Act 2003, in particular with reference to those 'interested parties' (see definition in guidance attached) who may lodge objections to applications for premises licences and who may make representations concerning existing premises licences. Unfortunately the Act does not define the term 'vicinity' but the licensing authority will determine each case on its individual merit.

If the licensing authority considers that relevant representations are made the licensing team will consider arranging a mediation meeting between the relevant parties (if all agree) to try and reach a settlement. If this informal process is unsuccessful a hearing before the Licensing Sub Committee will follow, unless the interested parties withdraw their representations.

All representations in their entirety, including your name and address will be disclosed to the applicant for the premises licence and the members of the [Sub]Committee, so that they can make an informal decision on the application.

Signed Helen E Owen Date 27th MAY 2014

HELEN E. S. OWEN
Please print name

Please return this form along with any additional sheets to:

The Licensing Team
Peterborough City Council
4th Floor Bayard Place
Broadway
Peterborough
PE1 1HZ

Telephone: 01733 453491

Email: eh.licensing@peterborough.gov.uk

This form must be returned within the Statutory Period, which is generally 28 days from the date on which the application was given to the licensing authority by the Applicant.

However, because of the tight timescales involved, and to assist in the determination of the application process, any representations should be forwarded to the licensing authority AS SOON AS POSSIBLE and preferably within 14 days of notification of the application.

If in any doubt, please contact the Licensing Team on the above telephone number.

THE LICENSING ACT 2003
REPRESENTATION FORM FOR INTERESTED PERSON / BODY
(living in the 'vicinity' of the premises detailed below)

Your name / Company name	A williams
(Name of Body you represent) Please tick one: • i) a person living in the vicinity of the premises <input checked="" type="checkbox"/> ii) a body representing persons who live in that vicinity <input type="checkbox"/> iii) a person involved in a business in the vicinity of the premises <input type="checkbox"/> iv) a body representing persons involved in these businesses <input type="checkbox"/>	
Postal Address (inc post code)	97 Wilsonhoft PE3 7LT
Contact telephone number:	
Mobile Number:	
Email address:	

Name of Premises you are making a representation about:	General Store Application Number: 069399
Address of the premises you are making a representation about:	48 Oundle Road, Peterborough. PE2 9PA

This section is about your representation/s. They must relate to one or more of the Licensing Objectives. Please detail the evidence supporting your representation, (under the relevant headings) and the reason for your representation/s. (Use additional sheets if necessary) *Regulations provide that in considering representations the authority may take into account documentary or othr information produced by the party either before the hearing or, with the consent of all parties, at the hearing.*

The prevention of crime and disorder To PREVENT CRIME & VIOLENCE in THESE AREA you HAVE TO LESSEN THE OFF LICENCES in THE AREA	Public safety THIS is a good AREA we doSNT want it To spoiled by ANY Alcohol Related incidences Problem
The prevention of public nuisance	The protection of children from harm CHILDREN can easily influences, by THESE THINGS.

Suggested conditions that could be added to the licence to remedy your representations, or other suggestions you would like the licensing authority to take into account

APPENDIX D

The term 'vicinity' is used in the Licensing Act 2003, in particular with reference to those 'interested parties' (see definition in guidance attached) who may lodge objections to applications for premises licences and who may make representations concerning existing premises licences. Unfortunately the Act does not define the term 'vicinity' but the licensing authority will determine each case on its individual merit.

If the licensing authority considers that relevant representations are made the licensing team will consider arranging a mediation meeting between the relevant parties (if all agree) to try and reach a settlement. If this informal process is unsuccessful a hearing before the Licensing Sub Committee will follow, unless the interested parties withdraw their representations.

All representations in their entirety, including your name and address will be disclosed to the applicant for the premises licence and the members of the [Sub]Committee, so that they can make an informal decision on the application.

Signed *R. Williams* Date *28.5.2014*

..... *R. Williams*
Please print name

Please return this form along with any additional sheets to:

The Licensing Team
Peterborough City Council
4th Floor Bayard Place
Broadway
Peterborough
PE1 1HZ

Telephone: 01733 453491

Email: eh.licensing@peterborough.gov.uk

This form must be returned within the Statutory Period, which is generally 28 days from the date on which the application was given to the licensing authority by the Applicant.

However, because of the tight timescales involved, and to assist in the determination of the application process, any representations should be forwarded to the licensing authority AS SOON AS POSSIBLE and preferably within 14 days of notification of the application.

If in any doubt, please contact the Licensing Team on the above telephone number.

THE LICENSING ACT 2003
REPRESENTATION FORM FOR INTERESTED PERSON / BODY
(living in the 'vicinity' of the premises detailed below)

Your name / Company name	HEATH CLARKE - MRS.
(Name of Body you represent) Please tick one: • i) a person living in the vicinity of the premises <input checked="" type="checkbox"/> ii) a body representing persons who live in that vicinity <input type="checkbox"/> iii) a person involved in a business in the vicinity of the premises <input type="checkbox"/> iv) a body representing persons involved in these businesses <input type="checkbox"/>	
Postal Address (inc post code)	38, GROVE COURT
Contact telephone number:	WOODSTON, PETERBOROUGH.
Mobile Number:	
Email address:	

Name of Premises you are making a representation about:	General Store Application Number: 069399
Address of the premises you are making a representation about:	48 Oundle Road, Peterborough. PE2 9PA

This section is about your representation/s. They must relate to one or more of the Licensing Objectives. Please detail the evidence supporting your representation, (under the relevant headings) and the reason for your representation/s. (Use additional sheets if necessary) *Regulations provide that in considering representations the authority may take into account documentary or other information produced by the party either before the hearing or, with the consent of all parties, at the hearing.*

The prevention of crime and disorder	Public safety
DRUNKEN BEHAVIOUR WILL INCREASE CRIME, TOO MANY SHOPS SELL BEER AROUND HERE.	LOT MORE TRAFFIC WILL MAKE HARDER FOR FAMILY WITH CHILDREN IN PRAMS AND PUSHCHAIRS.
The prevention of public nuisance	The protection of children from harm
ANTI SOCIAL BEHAVIOUR, LITTER, BROKEN GATES, FENCE	

Suggested conditions that could be added to the licence to remedy your representations, or other suggestions you would like the licensing authority to take into account

APPENDIX D

The term 'vicinity' is used in the Licensing Act 2003, in particular with reference to those 'interested parties' (see definition in guidance attached) who may lodge objections to applications for premises licences and who may make representations concerning existing premises licences. Unfortunately the Act does not define the term 'vicinity' but the licensing authority will determine each case on its individual merit.

If the licensing authority considers that relevant representations are made the licensing team will consider arranging a mediation meeting between the relevant parties (if all agree) to try and reach a settlement. If this informal process is unsuccessful a hearing before the Licensing Sub Committee will follow, unless the interested parties withdraw their representations.

All representations in their entirety, including your name and address will be disclosed to the applicant for the premises licence and the members of the [Sub]Committee, so that they can make an informal decision on the application.

Signed H. Clarke Date 28-5-14

HEATHER CLARKE
Please print name

Please return this form along with any additional sheets to:

The Licensing Team
Peterborough City Council
4th Floor Bayard Place
Broadway
Peterborough
PE1 1HZ

Telephone: 01733 453491

Email: eh.licensing@peterborough.gov.uk

This form must be returned within the Statutory Period, which is generally 28 days from the date on which the application was given to the licensing authority by the Applicant.

However, because of the tight timescales involved, and to assist in the determination of the application process, any representations should be forwarded to the licensing authority AS SOON AS POSSIBLE and preferably within 14 days of notification of the application.

If in any doubt, please contact the Licensing Team on the above telephone number.

**THE LICENSING ACT 2003
REPRESENTATION FORM FOR INTERESTED PERSON / BODY
(living in the 'vicinity' of the premises detailed below)**

Your name / Company name	ZORICA DJUKIC
(Name of Body you represent) Please tick one: • i) a person living in the vicinity of the premises <input checked="" type="checkbox"/> ii) a body representing persons who live in that vicinity <input type="checkbox"/> iii) a person involved in a business in the vicinity of the premises <input type="checkbox"/> iv) a body representing persons involved in these businesses <input type="checkbox"/>	
Postal Address (inc post code)	143 PALMERSTON ROAD PE2 9DE
Contact telephone number:	<input type="text"/>
Mobile Number:	<input type="text"/>
Email address:	

Name of Premises you are making a representation about:	General Store Application Number: 069399
Address of the premises you are making a representation about:	48 Oundle Road, Peterborough. PE2 9PA

This section is about your representation/s. They must relate to one or more of the Licensing Objectives. Please detail the evidence supporting your representation, (under the relevant headings) and the reason for your representation/s. (Use additional sheets if necessary) *Regulations provide that in considering representations the authority may take into account documentary or othr information produced by the party either before the hearing or, with the consent of all parties, at the hearing.*

The prevention of crime and disorder If more alcohol we sale more crime will occur.	Public safety Breakage of glass, cans and d'us all over the place increase scare for children specially safety.
---	---

The prevention of public nuisance Late night opening and sale of alcohol will increase nuisance, disturbances, noise and safety.	The protection of children from harm Drunk people gathering in the evening even during the day and cause trouble. and increase under age drinking & smoking.
--	--

Suggested conditions that could be added to the licence to remedy your representations, or other suggestions you would like the licensing authority to take into account

APPENDIX D

The term 'vicinity' is used in the Licensing Act 2003, in particular with reference to those 'interested parties' (see definition in guidance attached) who may lodge objections to applications for premises licences and who may make representations concerning existing premises licences. Unfortunately the Act does not define the term 'vicinity' but the licensing authority will determine each case on its individual merit.

If the licensing authority considers that relevant representations are made the licensing team will consider arranging a mediation meeting between the relevant parties (if all agree) to try and reach a settlement. If this informal process is unsuccessful a hearing before the Licensing Sub Committee will follow, unless the interested parties withdraw their representations.

All representations in their entirety, including your name and address will be disclosed to the applicant for the premises licence and the members of the [Sub]Committee, so that they can make an informal decision on the application.

Signed Zorka Djukic Date 28/05/2014

ZORKA DJUKIC
Please print name

Please return this form along with any additional sheets to:

The Licensing Team
Peterborough City Council
4th Floor Bayard Place
Broadway
Peterborough
PE1 1HZ

Telephone: 01733 453491

Email: eh.licensing@peterborough.gov.uk

This form must be returned within the Statutory Period, which is generally 28 days from the date on which the application was given to the licensing authority by the Applicant.

However, because of the tight timescales involved, and to assist in the determination of the application process, any representations should be forwarded to the licensing authority AS SOON AS POSSIBLE and preferably within 14 days of notification of the application.

If in any doubt, please contact the Licensing Team on the above telephone number.

16

APPENDIX D

THE LICENSING ACT 2003
REPRESENTATION FORM FOR INTERESTED PERSON / BODY
(living in the 'vicinity' of the premises detailed below)

Your name / Company name	MISS A-J- PAGETT-BROWN
(Name of Body you represent) Please tick one: i) a person living in the vicinity of the premises <input checked="" type="checkbox"/> ii) a body representing persons who live in that vicinity <input type="checkbox"/> iii) a person involved in a business in the vicinity of the premises <input type="checkbox"/> iv) a body representing persons involved in these businesses <input type="checkbox"/>	
Postal Address (inc post code)	22 GROVE COURT PE2 9AS
Contact telephone number:	
Mobile Number:	N/A
Email address:	

Name of Premises you are making a representation about:	General Store Application Number: 069399
Address of the premises you are making a representation about:	48 Oundle Road, Peterborough. PE2 9PA

This section is about your representation/s. They must relate to one or more of the Licensing Objectives. Please detail the evidence supporting your representation, (under the relevant headings) and the reason for your representation/s. (Use additional sheets if necessary) Regulations provide that in considering representations the authority may take into account documentary or othr information produced by the party either before the hearing or, with the consent of all parties, at the hearing.

The prevention of crime and disorder our LOCAL COMMUNITY already enough license PREMISES & TESCO'S JUST opening - There is NO NEED AS WE HAVE ALL DIFFERENT VARIETYS OF ALCOHOL AVAILABLE	Public safety TOO MANY PEOPLE seem to be hanging around premises waiting & talking at any one time. It is becoming like a meeting point THIS makes it difficult to get by when walking and people
The prevention of public nuisance Already people hanging around outside premises its like a public meeting place. causes congestion Alcohol on the premises will add to possible Aggravation	The protection of children from harm Children don't ALWAYS USE ROAD SAFETY and ride bikes to get their sweets etc. IT would be easy to ride off the pavement to Avoid people just standing and talking in one area
Suggested conditions that could be added to the licence to remedy your representations, or other suggestions you would like the licensing authority to take into account MRS SINGH & FAMILY ARE A PART OF OUR LOCAL COMMUNITY & HAVE A LOT OF SUPPORT FROM LOCAL RESIDENTS ALL THE TIME. THEY ARE A HARD WORKING FAMILY & DO PROVIDE FOR THEIR CUSTOMERS. I MYSELF HAVE LIVED IN WOODSTON ALL MY LIFE.	

APPENDIX D

The term 'vicinity' is used in the Licensing Act 2003, in particular with reference to those 'interested parties' (see definition in guidance attached) who may lodge objections to applications for premises licences and who may make representations concerning existing premises licences. Unfortunately the Act does not define the term 'vicinity' but the licensing authority will determine each case on its individual merit.

If the licensing authority considers that relevant representations are made the licensing team will consider arranging a mediation meeting between the relevant parties (if all agree) to try and reach a settlement. If this informal process is unsuccessful a hearing before the Licensing Sub Committee will follow, unless the interested parties withdraw their representations.

All representations in their entirety, including your name and address will be disclosed to the applicant for the premises licence and the members of the [Sub]Committee, so that they can make an informal decision on the application.

Signed Mrs A J Pagett Brown Date 27/5/14

A J PAGETT BROWN
Please print name

Please return this form along with any additional sheets to:

The Licensing Team
Peterborough City Council
4th Floor Bayard Place
Broadway
Peterborough
PE1 1HZ

Telephone: 01733 453491

Email: eh.licensing@peterborough.gov.uk

This form must be returned within the Statutory Period, which is generally 28 days from the date on which the application was given to the licensing authority by the Applicant.

However, because of the tight timescales involved, and to assist in the determination of the application process, any representations should be forwarded to the licensing authority AS SOON AS POSSIBLE and preferably within 14 days of notification of the application.

If in any doubt, please contact the Licensing Team on the above telephone number.

THE LICENSING ACT 2003
REPRESENTATION FORM FOR INTERESTED PERSON / BODY
(living in the 'vicinity' of the premises detailed below)

Your name / Company name	Vikki Rogalla
(Name of Body you represent) Please tick one: • i) a person living in the vicinity of the premises <input checked="" type="checkbox"/> ii) a body representing persons who live in that vicinity <input type="checkbox"/> iii) a person involved in a business in the vicinity of the premises <input type="checkbox"/> iv) a body representing persons involved in these businesses <input type="checkbox"/>	
Postal Address (inc post code)	PE2 9AR 6 ORChard Mews
Contact telephone number:	01753 811111
Mobile Number:	
Email address:	

Name of Premises you are making a representation about:	General Store Application Number: 069399
Address of the premises you are making a representation about:	48 Oundle Road, Peterborough. PE2 9PA

This section is about your representation/s. They must relate to one or more of the Licensing Objectives. Please detail the evidence supporting your representation, (under the relevant headings) and the reason for your representation/s. (Use additional sheets if necessary) *Regulations provide that in considering representations the authority may take into account documentary or othr information produced by the party either before the hearing or, with the consent of all parties, at the hearing.*

The prevention of crime and disorder	Public safety
To many people drink	footPath difficults with drunk drunk people
The prevention of public nuisance	The protection of children from harm
Litter noise	I have to come every day with my child.

Suggested conditions that could be added to the licence to remedy your representations, or other suggestions you would like the licensing authority to take into account

APPENDIX D

The term 'vicinity' is used in the Licensing Act 2003, in particular with reference to those 'interested parties' (see definition in guidance attached) who may lodge objections to applications for premises licences and who may make representations concerning existing premises licences. Unfortunately the Act does not define the term 'vicinity' but the licensing authority will determine each case on its individual merit.

If the licensing authority considers that relevant representations are made the licensing team will consider arranging a mediation meeting between the relevant parties (if all agree) to try and reach a settlement. If this informal process is unsuccessful a hearing before the Licensing Sub Committee will follow, unless the interested parties withdraw their representations.

All representations in their entirety, including your name and address will be disclosed to the applicant for the premises licence and the members of the [Sub]Committee, so that they can make an informal decision on the application.

Signed Vikki Rogalla..... Date 28/5/14.....

Vikki Rogalla
Please print name

Please return this form along with any additional sheets to:

The Licensing Team
Peterborough City Council
4th Floor Bayard Place
Broadway
Peterborough
PE1 1HZ

Telephone: 01733 453491

Email: eh.licensing@peterborough.gov.uk

This form must be returned within the Statutory Period, which is generally 28 days from the date on which the application was given to the licensing authority by the Applicant.

However, because of the tight timescales involved, and to assist in the determination of the application process, any representations should be forwarded to the licensing authority AS SOON AS POSSIBLE and preferably within 14 days of notification of the application.

If in any doubt, please contact the Licensing Team on the above telephone number.

**THE LICENSING ACT 2003
REPRESENTATION FORM FOR INTERESTED PERSON / BODY
(living in the 'vicinity' of the premises detailed below)**

Your name / Company name	DARREN REYNOLDS
(Name of Body you represent) Please tick one: • i) a person living in the vicinity of the premises <input checked="" type="checkbox"/> ii) a body representing persons who live in that vicinity <input type="checkbox"/> iii) a person involved in a business in the vicinity of the premises <input type="checkbox"/> iv) a body representing persons involved in these businesses <input type="checkbox"/>	
Postal Address (inc post code)	9 ROBINS CLOSE, BELLO
Contact telephone number:	<input style="border: 1px solid red;" type="text"/>
Mobile Number:	
Email address:	

Name of Premises you are making a representation about:	General Store Application Number: 069399
Address of the premises you are making a representation about:	48 Oundle Road, Peterborough. PE2 9PA

This section is about your representation/s. They must relate to one or more of the Licensing Objectives. Please detail the evidence supporting your representation, (under the relevant headings) and the reason for your representation/s. (Use additional sheets if necessary) Regulations provide that in considering representations the authority may take into account documentary or other information produced by the party either before the hearing or, with the consent of all parties, at the hearing.

<p>The prevention of crime and disorder</p> <p>To many drunk people</p>	<p>Public safety</p> <p>Parking problems difficult for m/s on foot path.</p>
<p>The prevention of public nuisance</p> <p>Litter & Drunken bottles</p>	<p>The protection of children from harm</p> <p>Substantial increase drinking money</p>

Suggested conditions that could be added to the licence to remedy your representations, or other suggestions you would like the licensing authority to take into account

APPENDIX D

The term 'vicinity' is used in the Licensing Act 2003, in particular with reference to those 'interested parties' (see definition in guidance attached) who may lodge objections to applications for premises licences and who may make representations concerning existing premises licences. Unfortunately the Act does not define the term 'vicinity' but the licensing authority will determine each case on its individual merit.

If the licensing authority considers that relevant representations are made the licensing team will consider arranging a mediation meeting between the relevant parties (if all agree) to try and reach a settlement. If this informal process is unsuccessful a hearing before the Licensing Sub Committee will follow, unless the interested parties withdraw their representations.

All representations in their entirety, including your name and address will be disclosed to the applicant for the premises licence and the members of the [Sub]Committee, so that they can make an informal decision on the application.

Signed  Date 

..... 
Please print name

Please return this form along with any additional sheets to:

The Licensing Team
Peterborough City Council
4th Floor Bayard Place
Broadway
Peterborough
PE1 1HZ

Telephone: 01733 453491

Email: eh.licensing@peterborough.gov.uk

This form must be returned within the Statutory Period, which is generally 28 days from the date on which the application was given to the licensing authority by the Applicant.

However, because of the tight timescales involved, and to assist in the determination of the application process, any representations should be forwarded to the licensing authority AS SOON AS POSSIBLE and preferably within 14 days of notification of the application.

If in any doubt, please contact the Licensing Team on the above telephone number.